

Mount-n-Lock™ HiLoHitch™ ShakeStopper™ Assembly Pictorial For H4HZ, H5HZ, and H6HZ Models

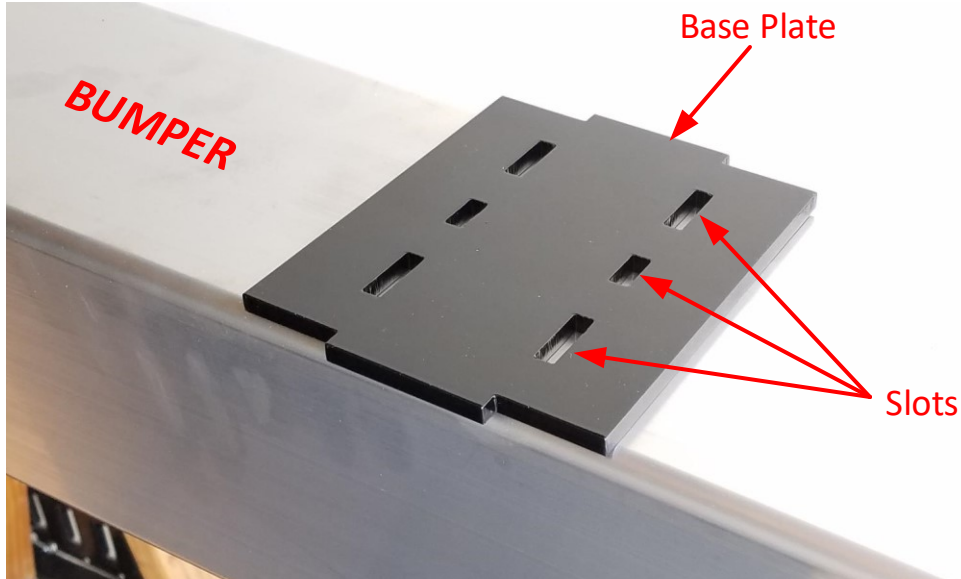

1. Set Base Plate on top of Bumper as shown.

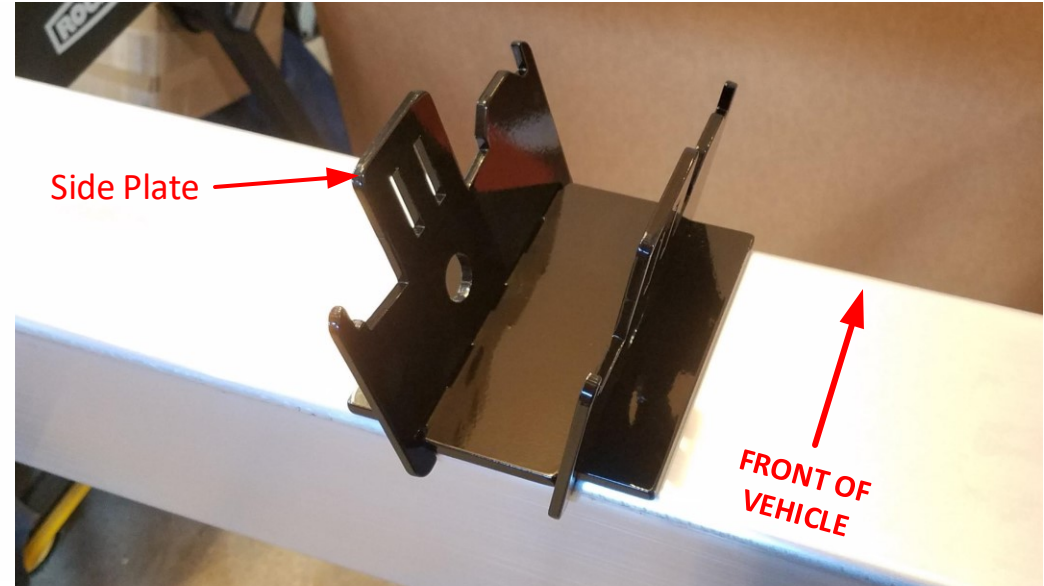

2. Properly orient Side Plates in relationship to front of vehicle as shown and insert into Slots of Base Plate. (Note: H4HZ Side Plates are reversible).

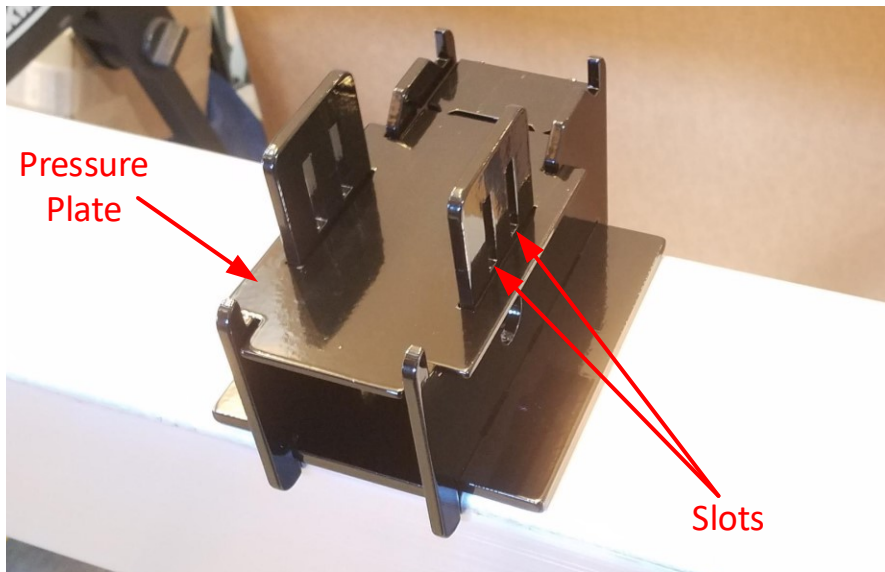

3. Set Pressure Plate atop Side Plates as shown (Note: H4HZ Pressure Plate is reversible).

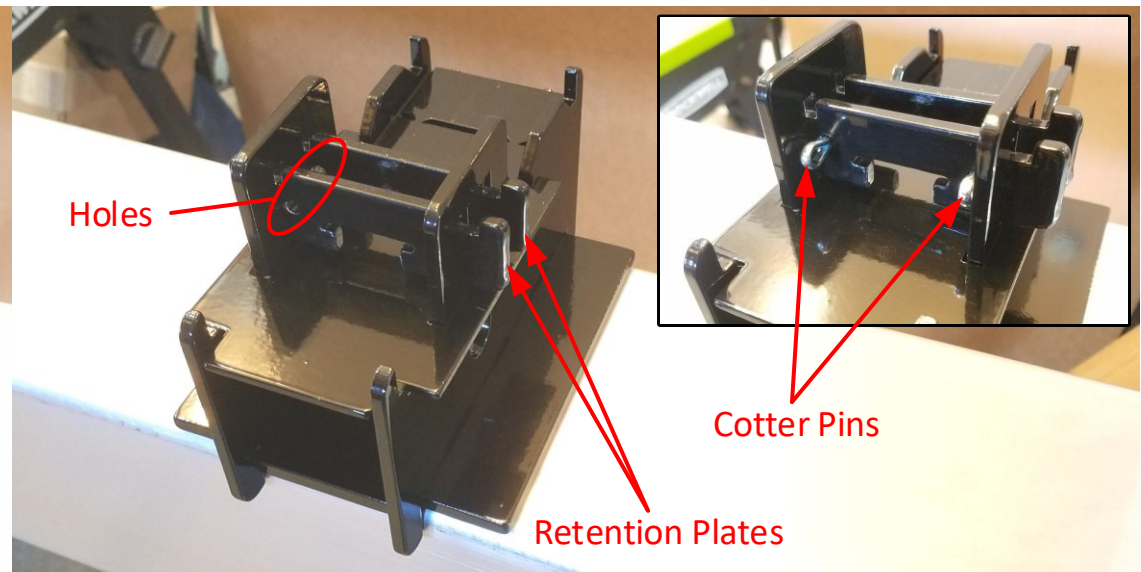

4. Slide 2 Retention Plates through slots in Side Plates with large center notch toward Pressure Plate. Insert 2 Cotter Pins into holes in plates; bend pin legs to hold in place.

Mount-n-Lock™ HiLoHitch™ ShakeStopper™ Assembly Pictorial For H4HZ, H5HZ, and H6HZ Models

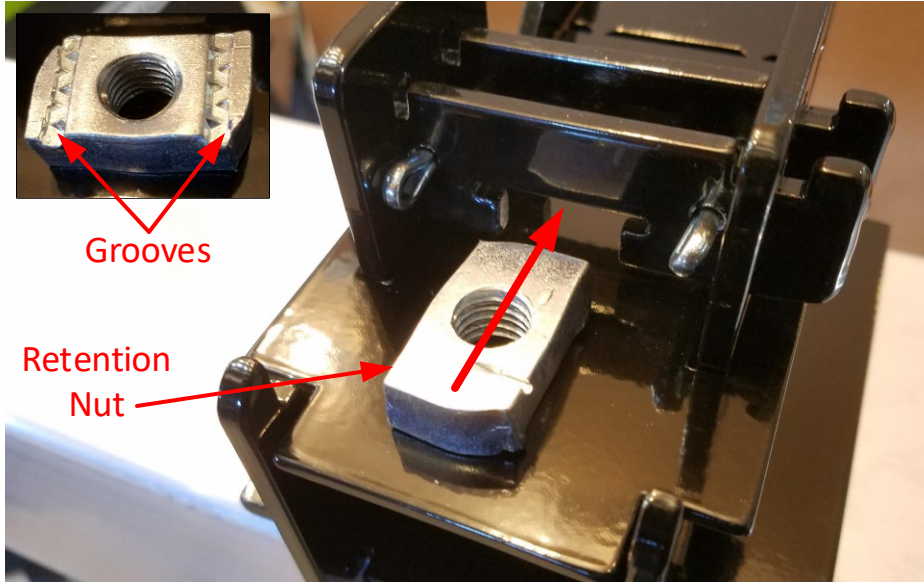

5. Slide Retention Nut through openings in Retention Plates. Center nut between plates (Note: Grooves in nut go against Pressure Plate).

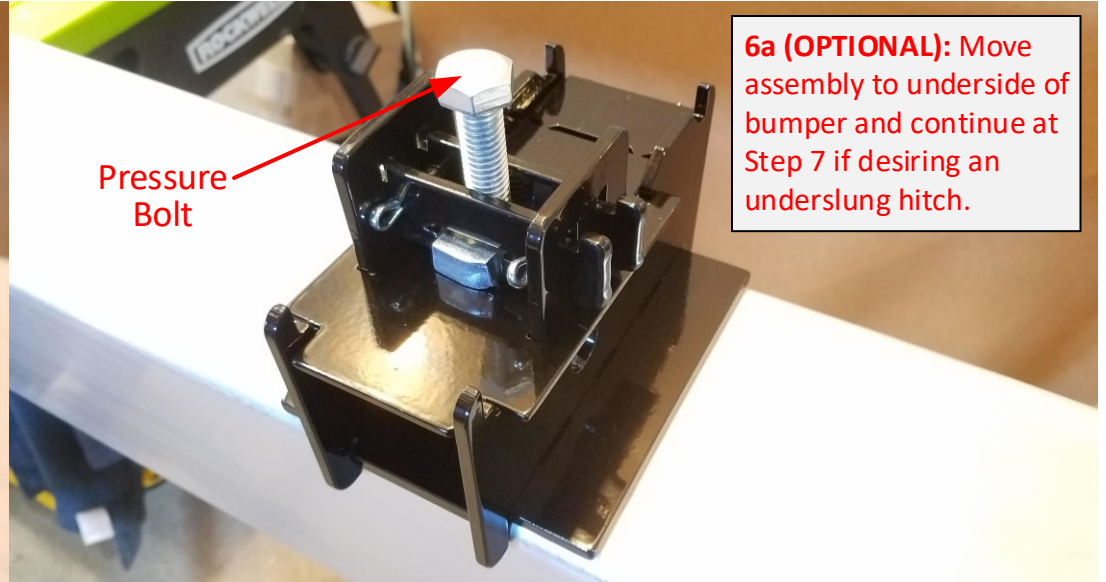

6a (OPTIONAL): Move assembly to underside of bumper and continue at Step 7 if desiring an underslung hitch.

6. Thread Pressure Bolt into Retention Nut until nut lifts Retention Plates and tip of bolt rests lightly against Pressure Plate. **DO NOT DEFORM PRESSURE PLATE!**

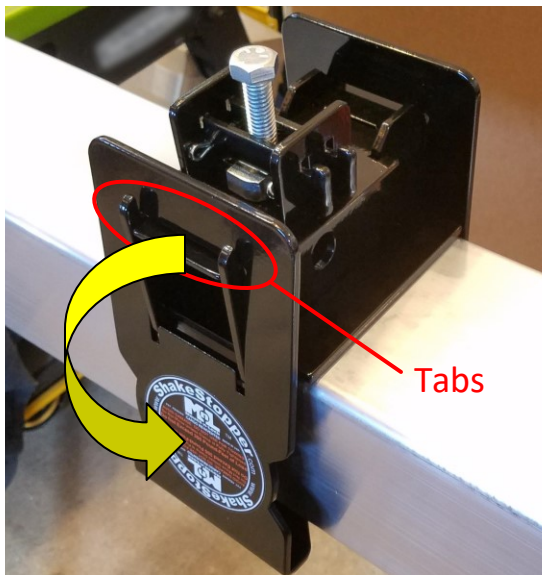

7. Add front and rear Face Plates. Hook Face Plates over Tabs on Side Plates and swing into place.

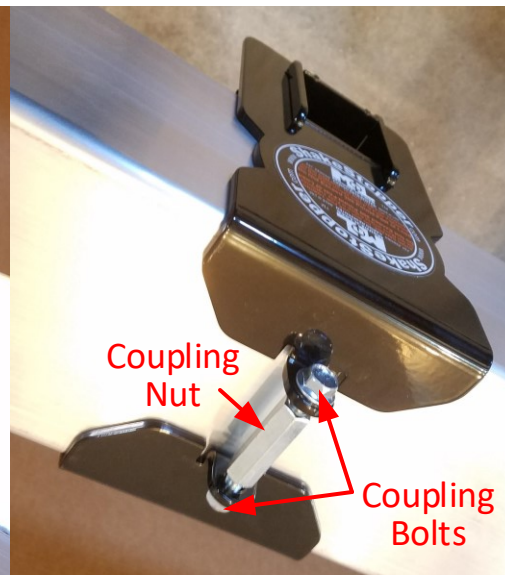

8. Connect Face Plates using Coupling Nut and Bolts. Finger tighten only. *Seeing exposed bolt threads is okay.*

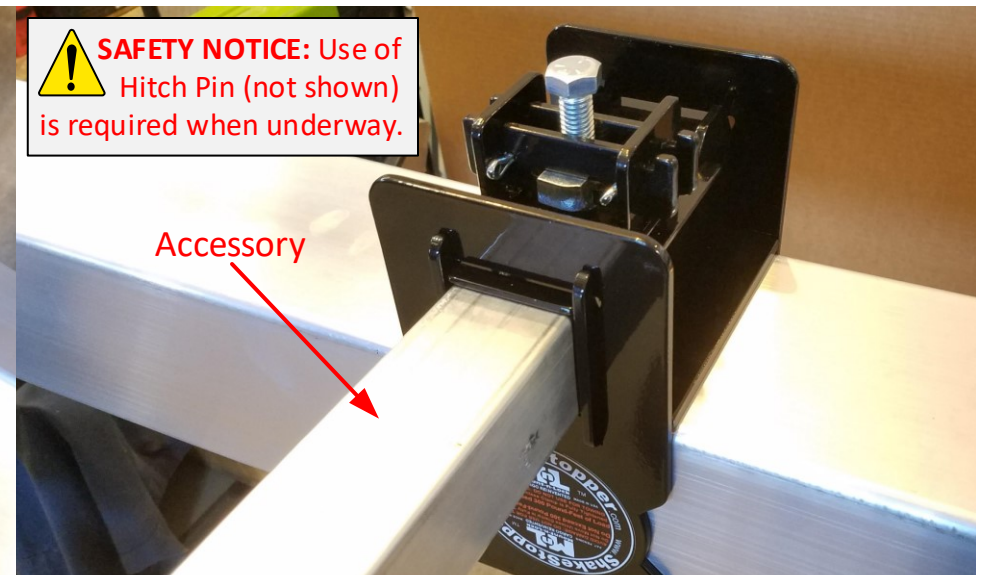

9. Insert Accessory into Hitch, tighten Pressure Bolt until no movement, then wrench-tighten Coupling Bolts to clamp Hitch to Bumper. Loosen Pressure Bolt to remove accessory. **Hitch is now ready to use!**

Visit www.mount-n-lock.com/installs for full-size instructions.